

An example of testing your existing foundation depth, by excavating to reveal the last brick or stone and calculate final levels after the conversion of your basement.

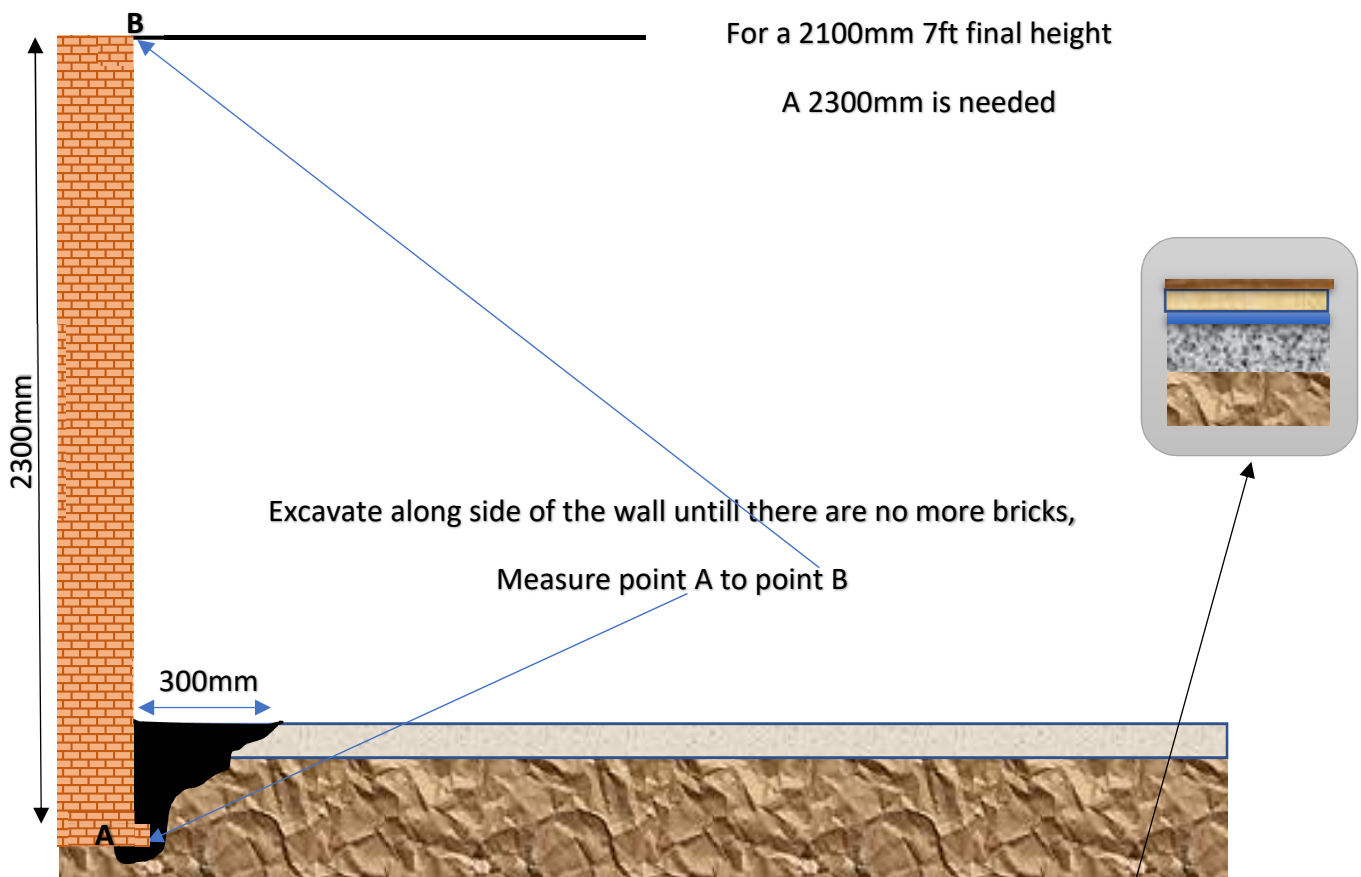
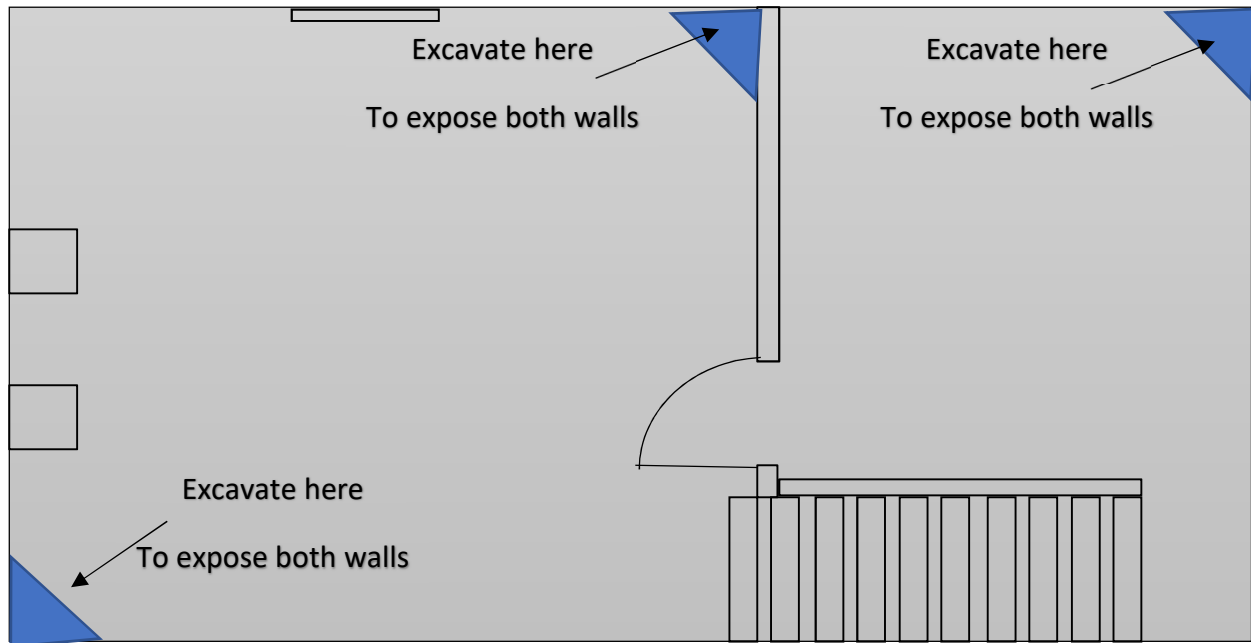

Example: $A+B = 2300\text{mm}$ now calculate: $2300-200 = 2100\text{mm}$

200mm is made up of 125mm concrete, 8mm floor membrane, 50mm insulation, 18 floor boards,